

Stage 7

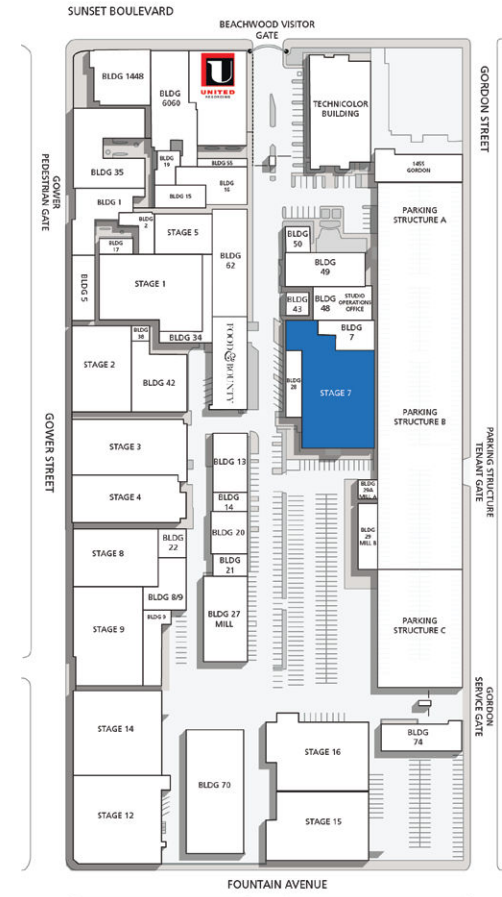

Width	Length	Height (Perms)	Total Stage Square Footage	Floor Type	Door (WxH)
106'9"	143'3"	29'	17,557	Concrete	11'11" x 17'

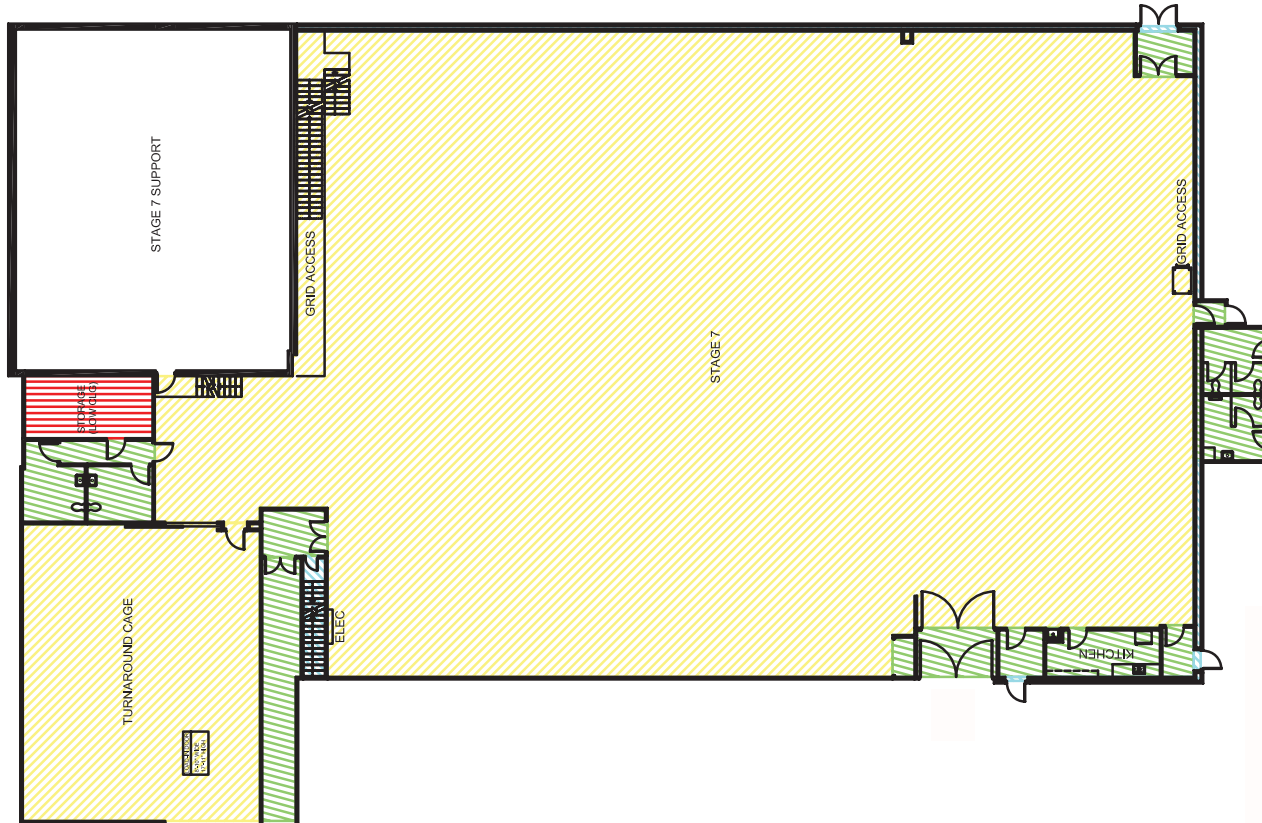
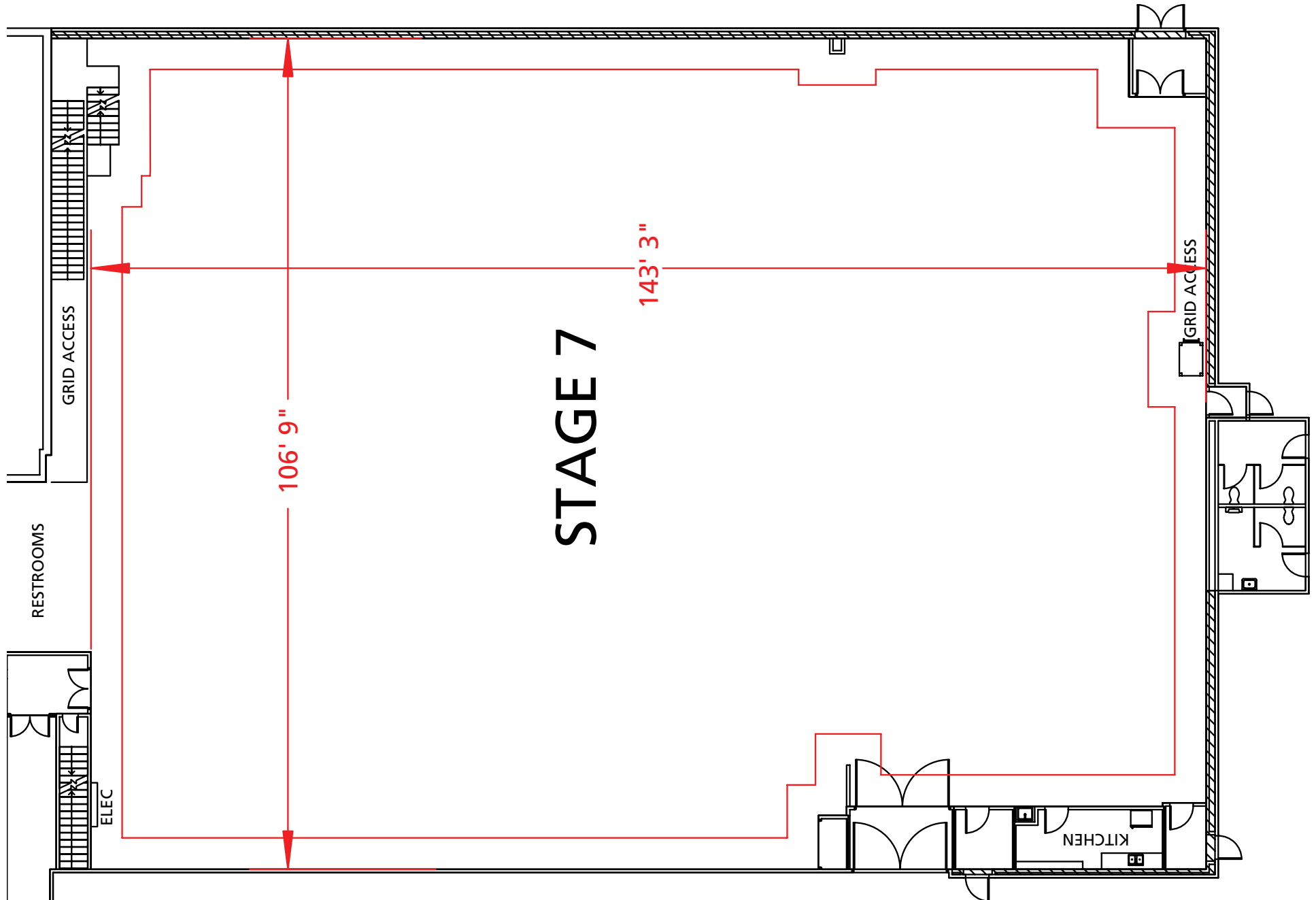

*Dimensions are for overall stage size and do not take into account stage irregularities. Production company representative should verify dimensions for particular applications.

Stage Specifications: Stage 7

Stage Specifications - (Dimensions Include 4' Fire Lane)

Width – 106' 9"
Length – 143' 3"
Height (Perms) – 29'
Total Square Footage – 17,557
Floor Type – Concrete
Elephant Door (W X H) – 11' 11" X 17'

Support Space- (Available On Stage)

Kitchen on stage with fridge.
Dressing Rooms, Wardrobe, and Hair + Make Up rooms are available in adjacent buildings

Heavy Equipment

Stage Management to authorize

Electric Service

Production Power - 120/208 800 Amp Per Phase Bus Bar, 4800 Amp Total Standard. Additional 2400 Amps Available
240 Volts - No
480 Volts - No
Tech Power - Available
Power In Grid - Available (Single Phase 120/208)

HVAC

HVAC - (2) 30 Ton (Nominal) Cooling Only Package Units.
25 Ton (Nominal) Cooling Only Package Unit
25 Ton (Nominal) Cooling/Heat Package Unit
Redlight Control - Yes
Ventilation - Yes
Heating - Yes

Stage Extras

Hose Bib - No
Gas - No
Drain - Yes
Compressed Air - No
Wireless Internet – Available
Phone – Available
Fax – Available