

Stage 5

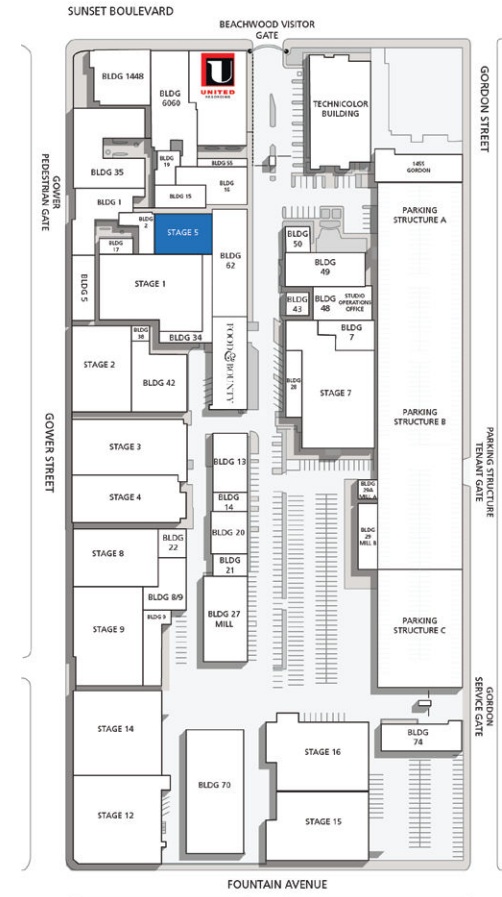

Width	Length	Height (Perms)	Total Stage Square Footage	Floor Type	Door (WxH)
55' 9-1/8"	85'8"	18'9"	5,720	Wood	7'6" x 13'2"

*Dimensions are for overall stage size and do not take into account stage irregularities. Production company representative should verify dimensions for particular applications.

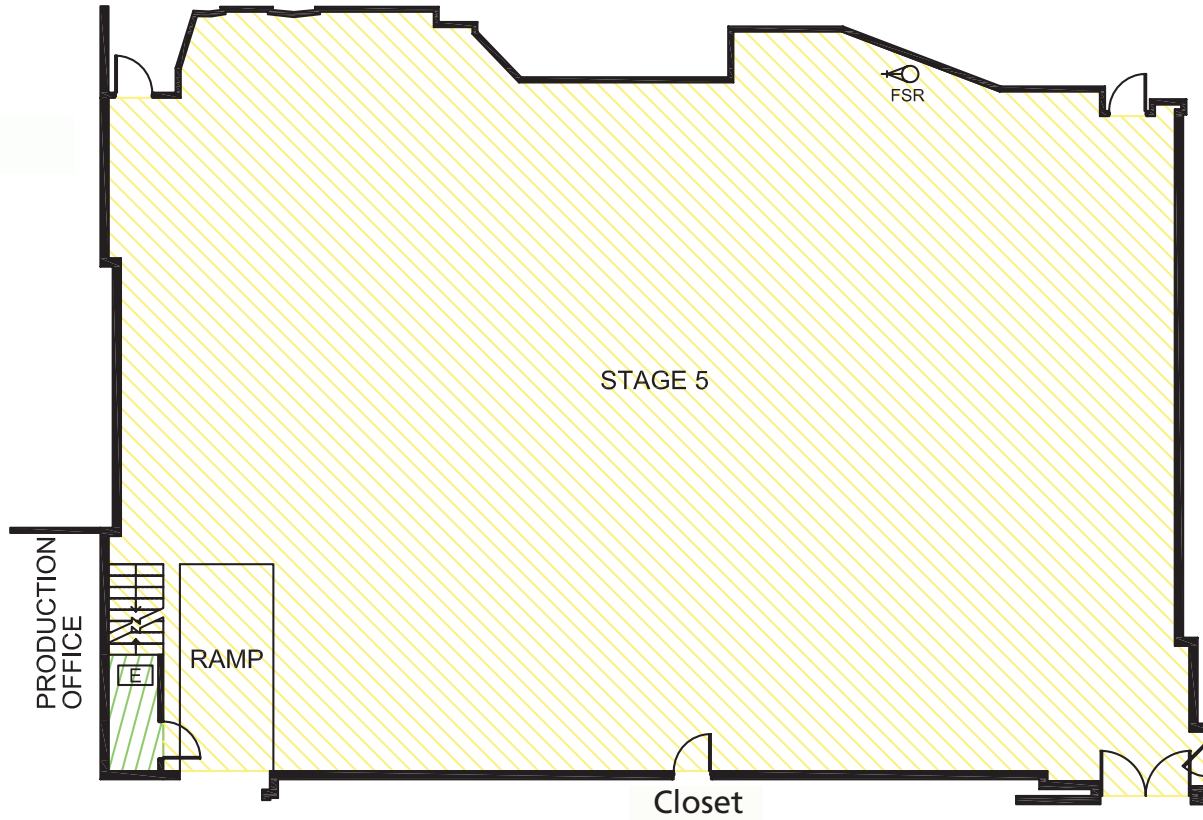
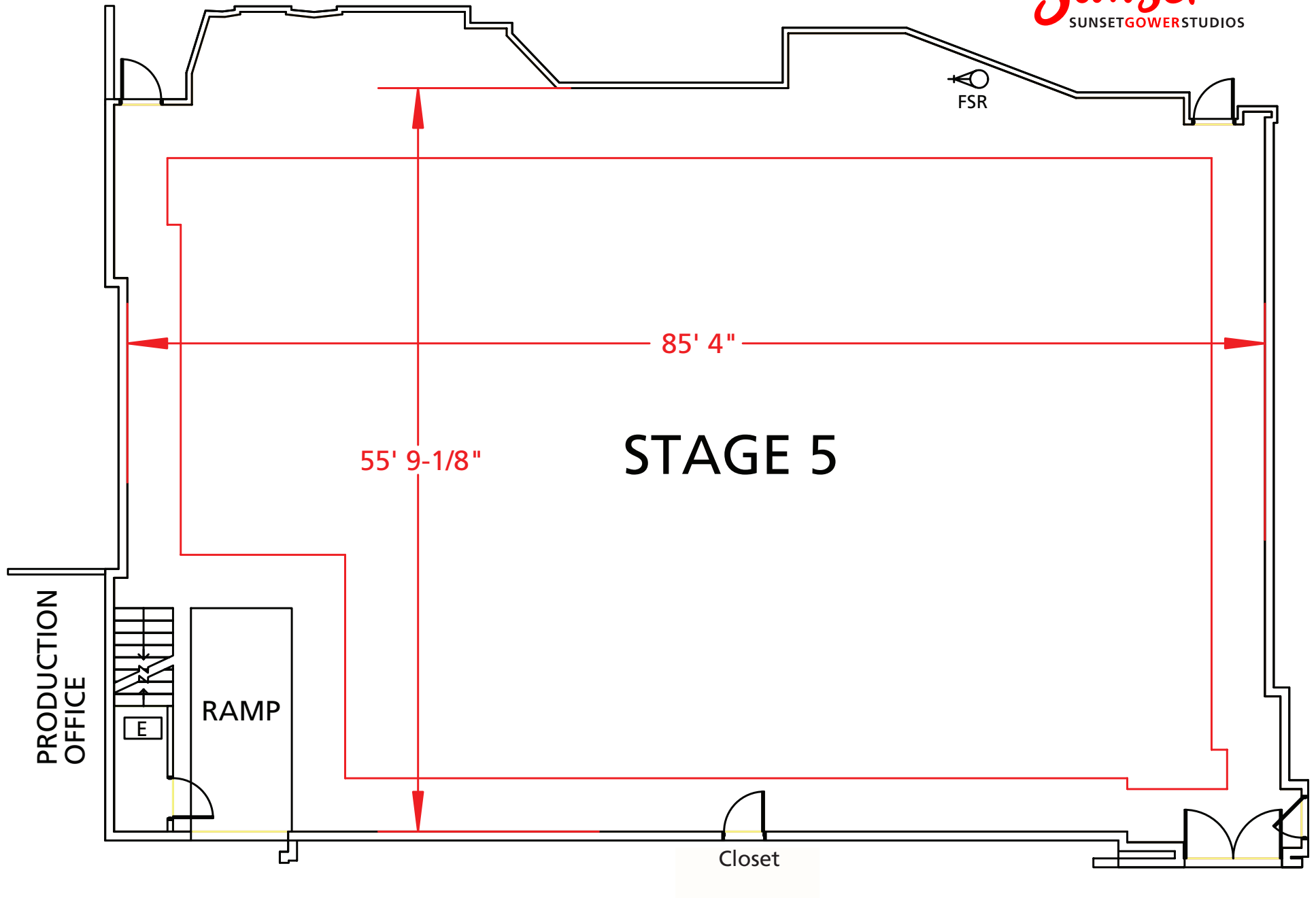

Stage Specifications: Stage 5

Stage Specifications - (Dimensions Include 4' Fire Lane)

Width – 55' 9-1/8"

Length – 85' 8'

Height (Perms) – 18' 9"

Total Square Footage – 5,720 sf

Floor Type – Wood

Elephant Door (W X H) – 7' 6" X 13' 2"

Support Space- (Available On Stage)

Greenrooms – 1, located onstage, up one flight of stairs

Dressing Rooms, Wardrobe, and Hair + MU rooms are available in adjacent buildings

Heavy Equipment

Stage Management to authorize

Electric Service

Production Power - 120/208 400 Amp Per Phase Bus Bar, 1200 Amp Total Standard. NO Additional Available

240 Volts - No

480 Volts - No

Tech Power - Available

Power In Grid - None

HVAC

HVAC- (1) 10 Ton (Nominal) Cooling/Heat Package Unit.

Redlight Control - Yes

Ventilation - Yes

Heating – Yes

Stage Extras

Hose Bib - No

Gas - No

Drain - No

Compressed Air – No

Wireless Internet – Available

Phone – Available

Fax – Available