

Stage 2

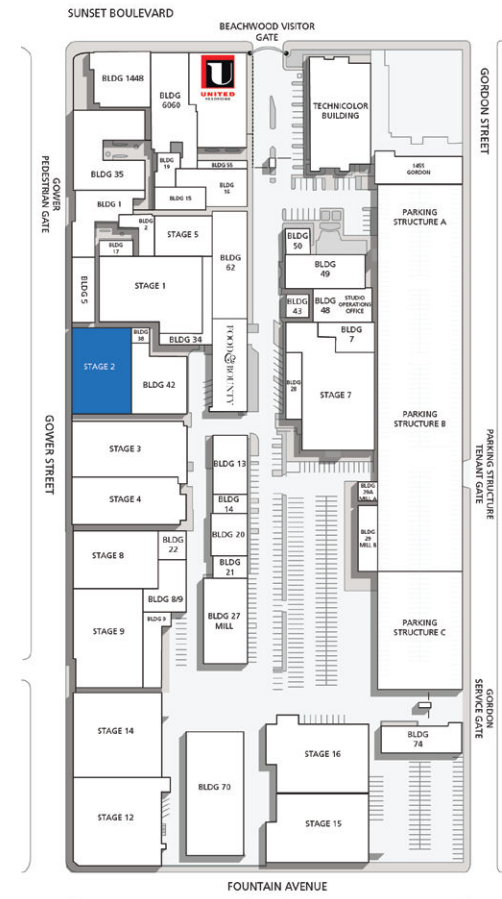

Width	Length	Height (Perms)	Total Stage Square Footage	Floor Type	Door (WxH)
89'	137'6"	23'6"	12,538	Wood	13' x 13' 11"

*Dimensions are for overall stage size and do not take into account stage irregularities. Production company representative should verify dimensions for particular applications.

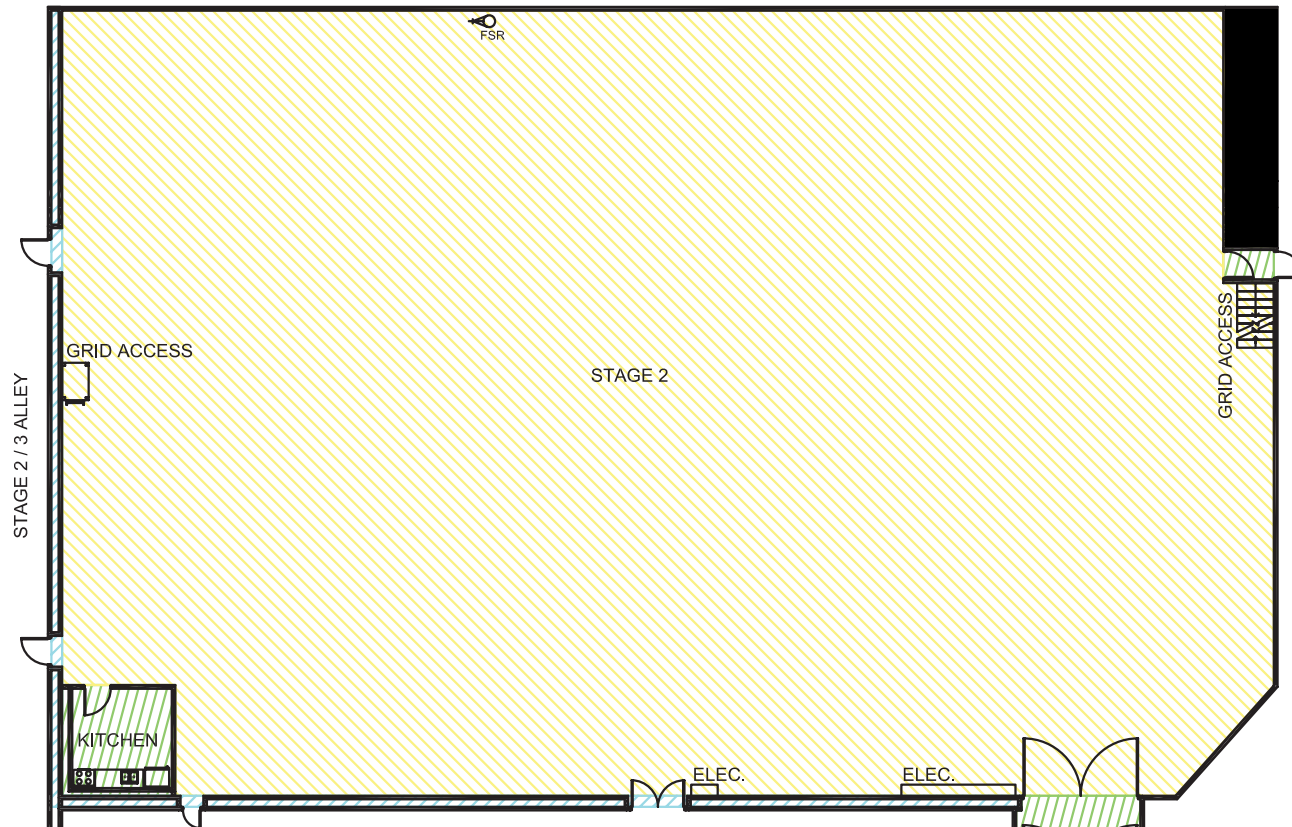
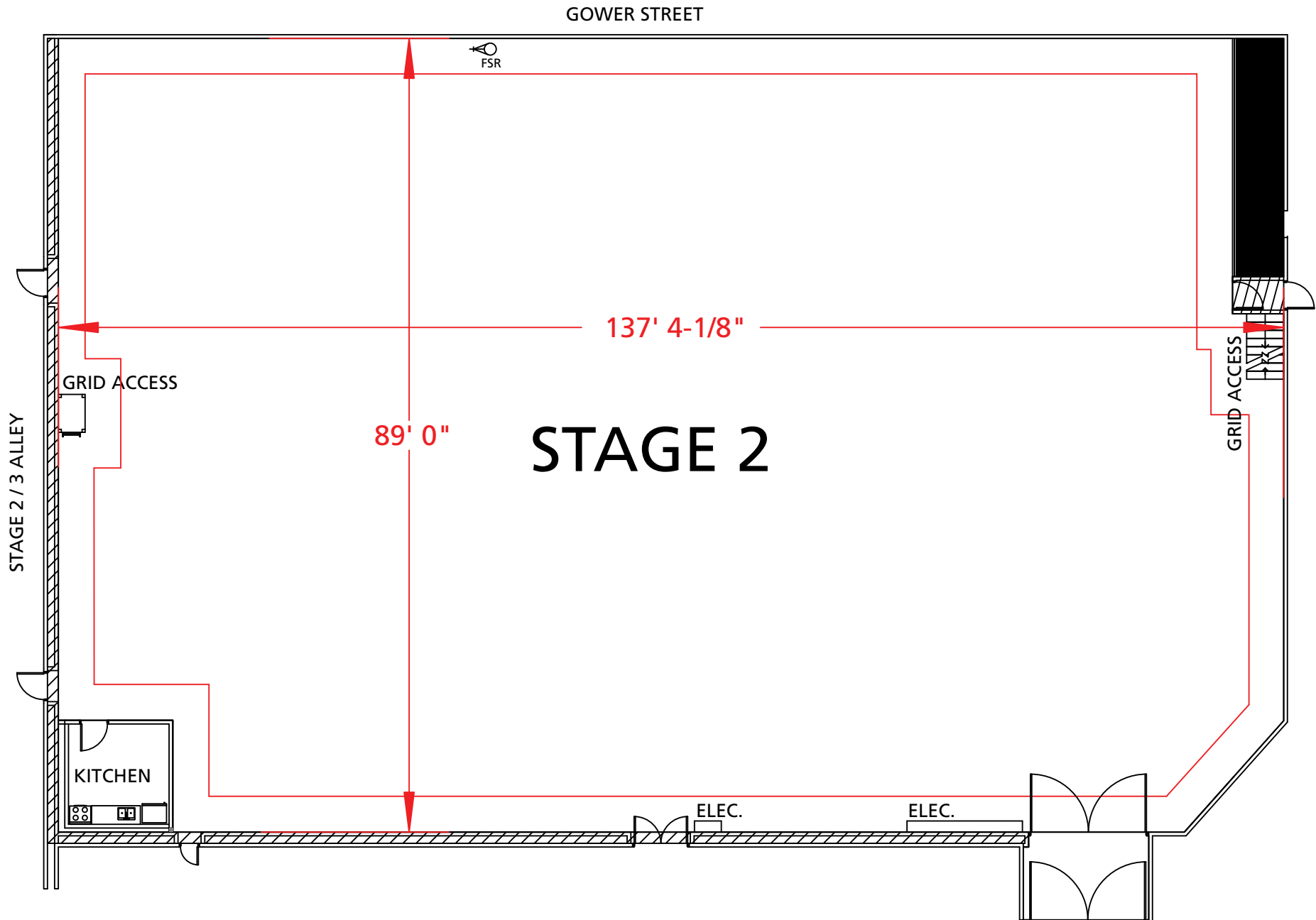

*Dimensions are for overall stage size and do not take into account stage irregularities. Production company representative should verify dimensions for particular applications.

Stage Specifications: Stage 2

Stage Specifications - (Dimensions Include 4' Fire Lane)

Width – 89'
Length – 137' 6"
Height (Perms) – 23' 6"
Total Square Footage – 12,538
Floor Type – Wood
Elephant Door (W X H) – 13'x 13' 11"

Support Space

Kitchen on stage.
Dressing Rooms, Wardrobe, and Hair + Make Up rooms are available in adjacent buildings

Heavy Equipment

Stage Management to authorize

Electric Service

Production Power - 120/208 800 Amp Per Phase Bus Bar, 2400 amp total standard. Additional 2400 Amps Available
240 Volts – No
480 Volts – No
Tech Power – Available
Power In Grid – Available (Single Phase 120/208)

HVAC

10 Ton (Nominal) Cooling Only Package Unit
15 Ton Cooling / Heat Package Unit
20 Ton Cooling / Heat Package Unit
33 Ton Cooling / Heat Package Unit
Redlight Control - Yes
Ventilation - Yes
Heating – Yes

Stage Extras

Hose Bib - No
Gas - No
Drain - Yes
Compressed Air - No
Wireless Internet – Available
Phone/Fax – Available