

Stage 1/2

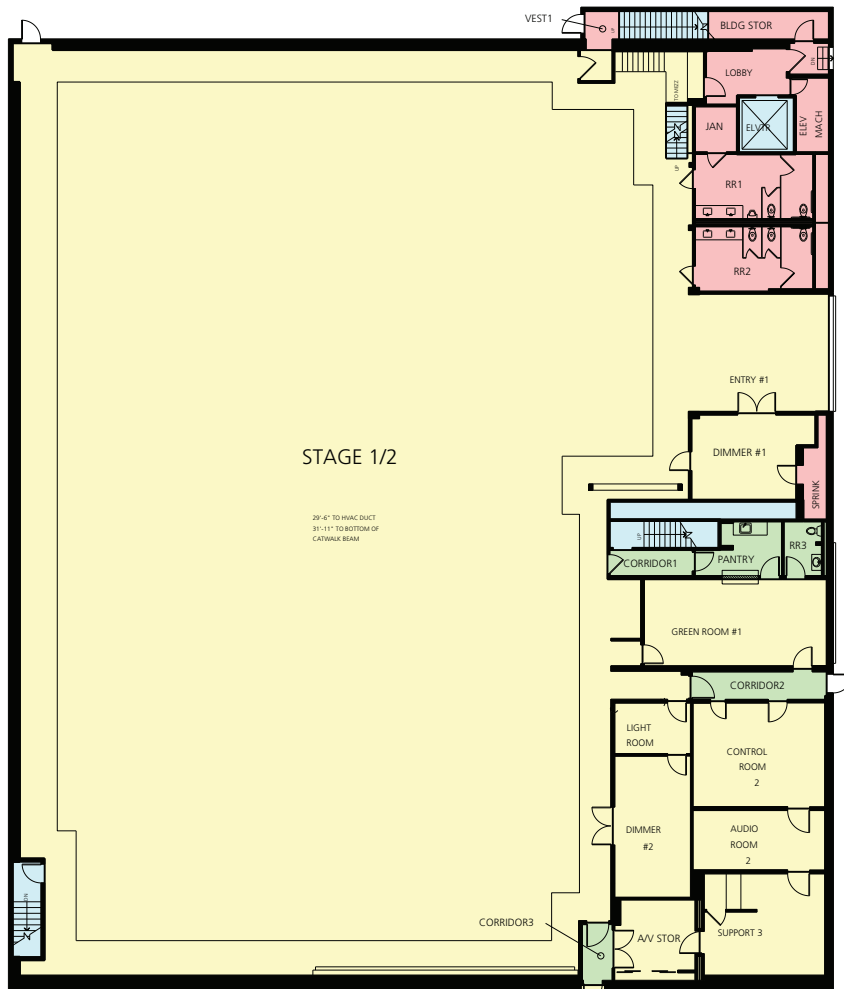

Width	Length	Height (Perms)	Total Stage Square Footage	Floor Type	Door (WxH)	Gross Weight Limit
147' 2 1/8"	106' 6 1/2"	30'	19,060	Wood	18'10" x 16'4"	12,000 Lbs.

*Dimensions are for overall stage size and do not take into account stage irregularities. Production company representative should verify dimensions for particular applications.

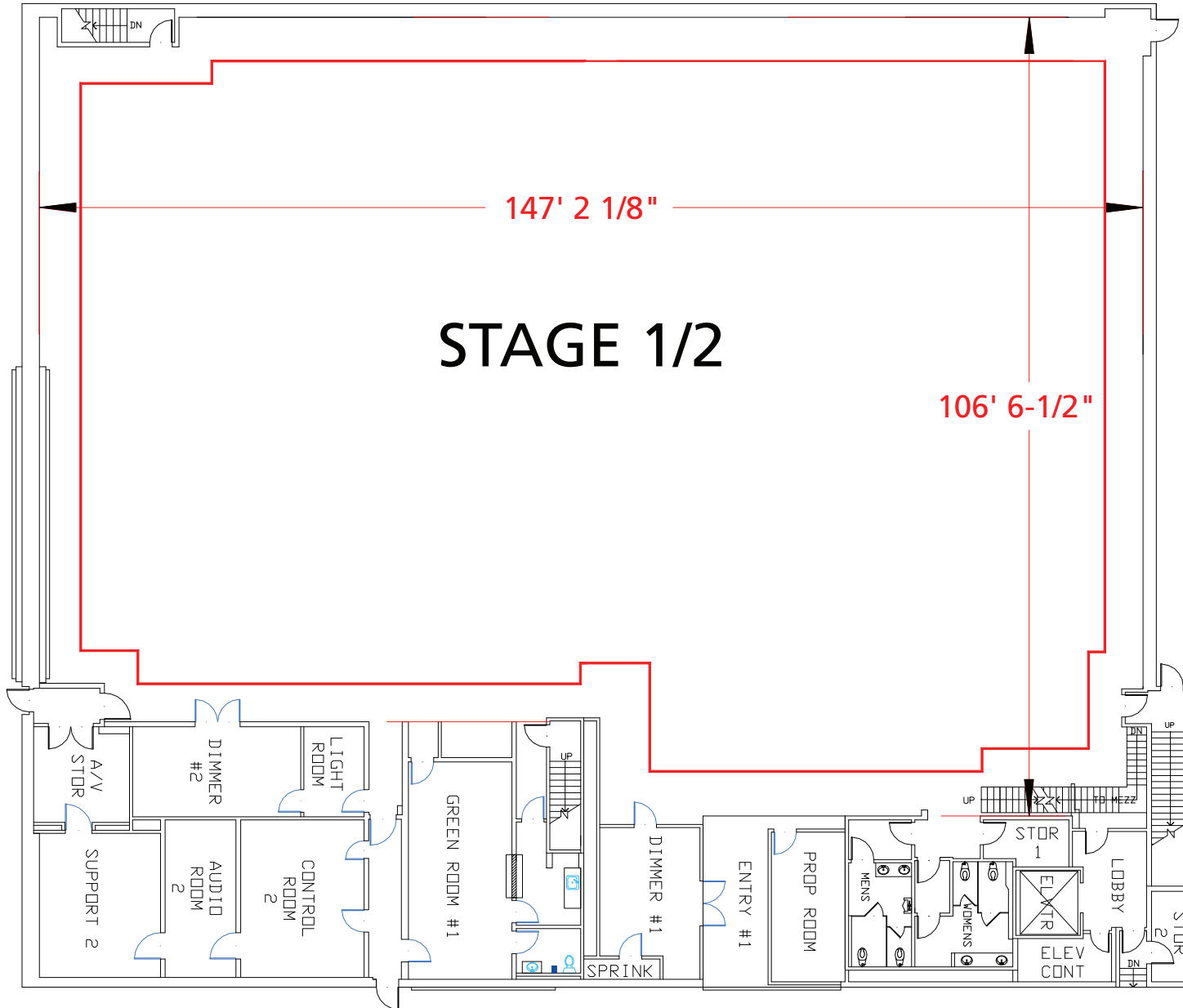

*Dimensions are for overall stage size and do not take into account stage irregularities. Production company representative should verify dimensions for particular applications.

Stage Specifications: Stage 1/2

Stage Specifications - (Dimensions Include 4' Fire Lane)

Width – 147' 2 1/8"
Length – 106' 6 1/2"
Height (Perms) – 30'
Total Square Footage – 19,060 sf
Floor Type – Wood
Elephant Door (W X H) – 18' 10" X 16' 4"
Gross Weight Limits - 12,000 lbs (No Load)
Full Service Control / Audio / Video Tape Room Available

Support Space- (Available On Stage)

Offices – 1
Dressing Rooms – 9
Make Up Rooms – 1
Wardrobe - 1
Greenrooms – 1 (2 Additional Upon Availability)
Galley - 1

Heavy Equipment – (Authorized Lifts)

32' Scissor – 3246ES
30' Articulating Boom – E300AJP
40' Articulation Boom – E400AJP

Electric Service

Production Power - 120/208 800 Amp Per Phase Bus Bar, 2400 amp total standard. Additional 7200 Amps Available
240 Volts – Accessible
480 Volts – No
Tech Power – Available
Power In Grid – Available (Single Phase 120/208)

HVAC

HVAC- (3) 20 Ton (Nominal) Cooling Only Package Units.
Redlight Control – Yes
Ventilation – No
Heating – No

Stage Extras

Hose Bib – Yes
Gas – Yes ; Compressed Air – No
Drain – Yes
Wireless Internet – Yes; Phone – Yes; Fax – No